

FAIRBANKS CITY HALL ROOF AND WINDOWS REPLACEMENT FAIRBANKS, ALASKA FB 99-11

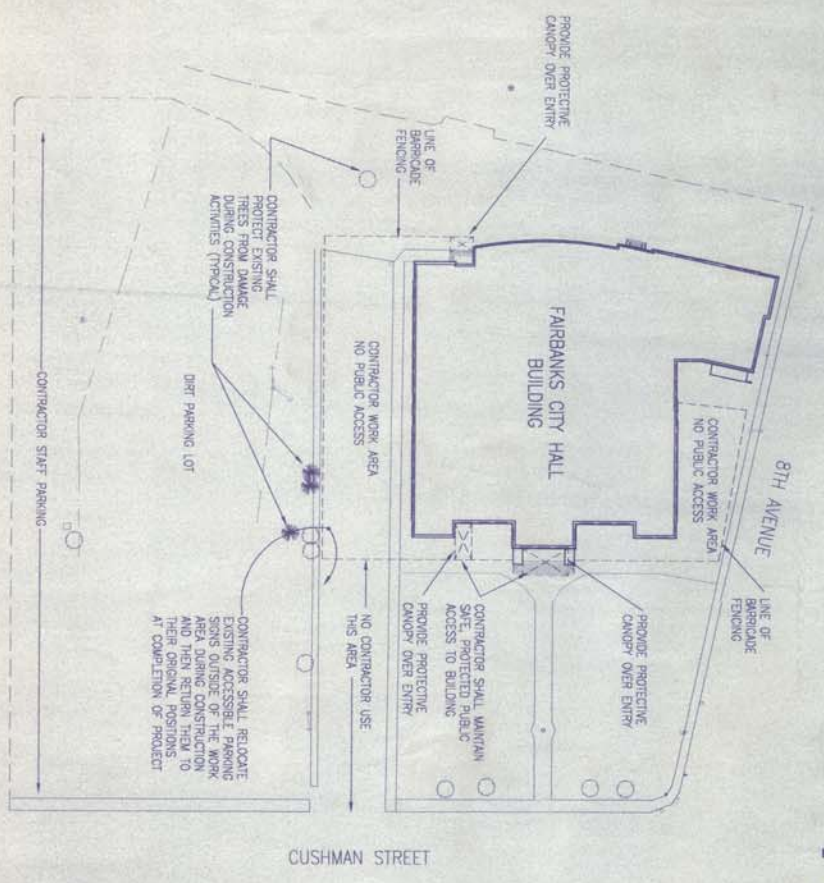

- GENERAL NOTES:**
1. THE ORIGINAL MAIN SCHOOL, NOW THE FAIRBANKS CITY HALL, WAS CONSTRUCTED IN THE 1930'S. SINCE THAT TIME THERE HAVE BEEN MULTIPLE BUILDING ADDITIONS. MINIMAL ORIGINAL DOCUMENTS FOR THE BUILDING ARE AVAILABLE FOR CONTRACTOR REVIEW. THE DOCUMENTS ARE AVAILABLE FOR CONTRACTOR REVIEW.
 2. THE CONSTRUCTION DOCUMENTS INDICATE GENERAL BUILDING CONDITIONS AND ARE PROVIDED TO SHOW DESIGN INTENT.
 3. THE CONTRACTOR IS RESPONSIBLE FOR INSPECTING THE BUILDING IN AREAS THAT WILL BE IMPACTED BY HIS WORK.
 4. THE CONTRACTOR SHALL OBTAIN FIELD MEASUREMENTS OF ANY CONDITION CRITICAL TO HIS WORK.
 5. DIMENSIONED CRITICAL SHOP DRAWINGS AND MATERIAL SUBMITTALS WILL NOT BE REVIEWED UNTIL THE CONTRACTOR CERTIFIES HE HAS FIELD VERIFIED THE EXISTING BUILDING CONDITIONS.

DRAWING INDEX	
G1	COVER SHEET DRAWING INDEX SITE PLAN GENERAL NOTES
G2	WORK AREAS PLAN HAZARDOUS MATERIALS ROOF PLAN AND ELEVATIONS
H21	ROOF PROJECT DEMOLITION PLAN
D1	ROOF PROJECT DEMOLITION PLAN
D2	ROOF PROJECT BUILDING SECTIONS
D3	ROOF PROJECT DEMOLITION BUILDING SECTIONS
A1	ROOF PROJECT ARCHITECTURAL ROOF PLAN
A2	ROOF PROJECT ARCHITECTURAL ATTIC PLAN
A3	ROOF PROJECT ARCHITECTURAL BUILDING SECTIONS
A4	ROOF PROJECT ARCHITECTURAL BUILDING SECTIONS
A5	ROOF PROJECT ARCHITECTURAL ROOFING DETAILS
A6	ROOF PROJECT ARCHITECTURAL ROOFING DETAILS
A7	WINDOWS PROJECT ARCHITECTURAL EXTENSION ELEVATIONS DETAILS
A8	WINDOWS PROJECT ARCHITECTURAL EXTENSION ELEVATIONS DETAILS
S1	ROOF PROJECT STRUCTURAL ROOF FRAMING PLAN
S2	ROOF PROJECT STRUCTURAL DETAILS
M1	ROOF PROJECT MECHANICAL ROOF PLAN
M2	ROOF PROJECT MECHANICAL ATTIC PLAN

1 SITE PLAN
1/8" = 10'-0"

