

4 DETAIL
1/8" = 1'-0"

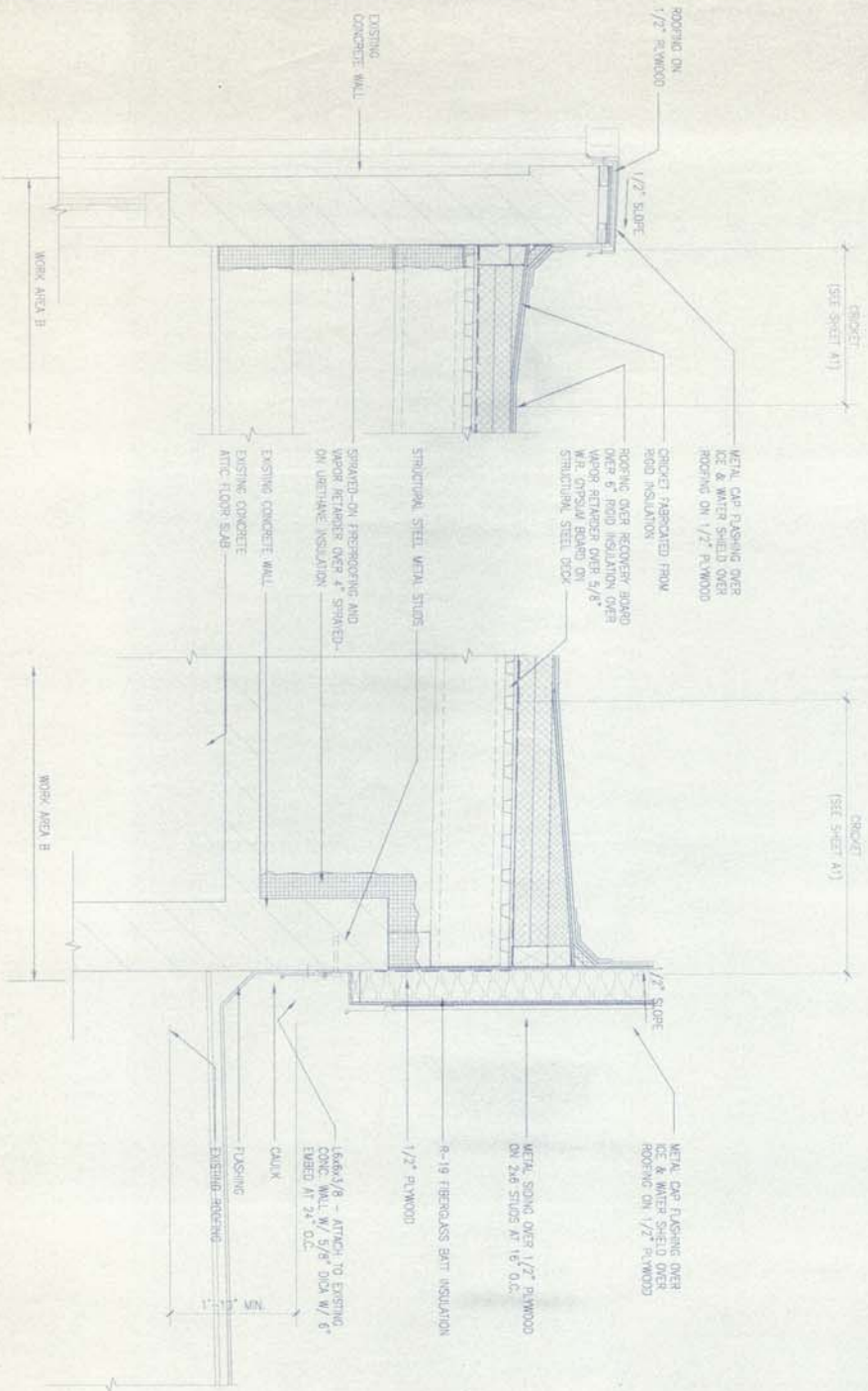

5 DETAIL
1/8" = 1'-0"

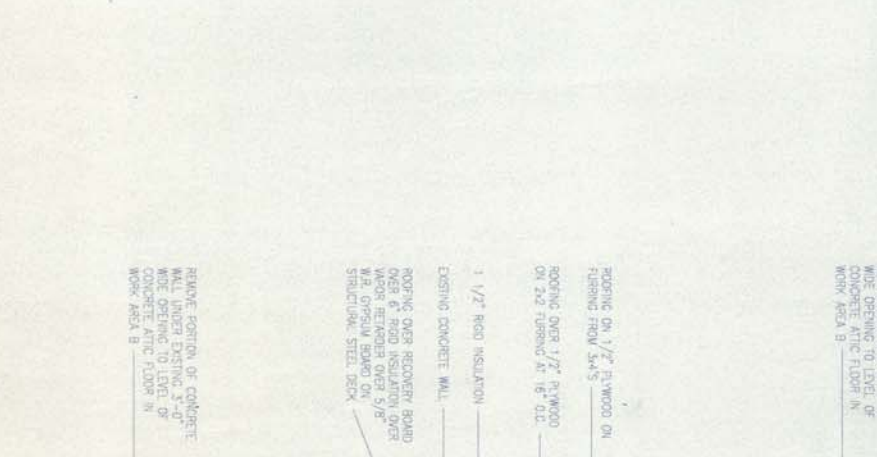

6 DETAIL
1/8" = 1'-0"

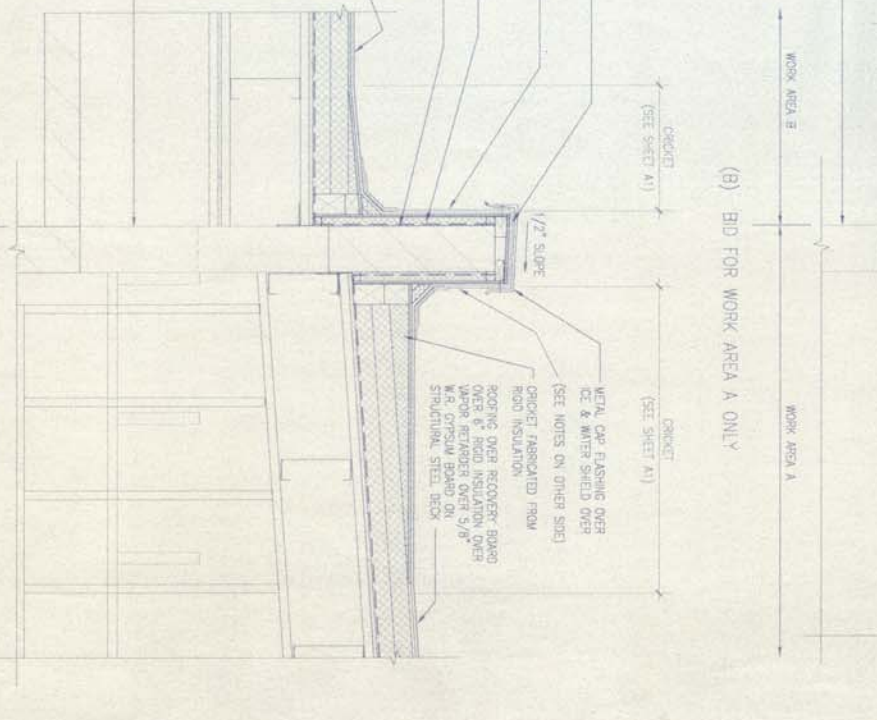

1 DETAIL
1/8" = 1'-0"

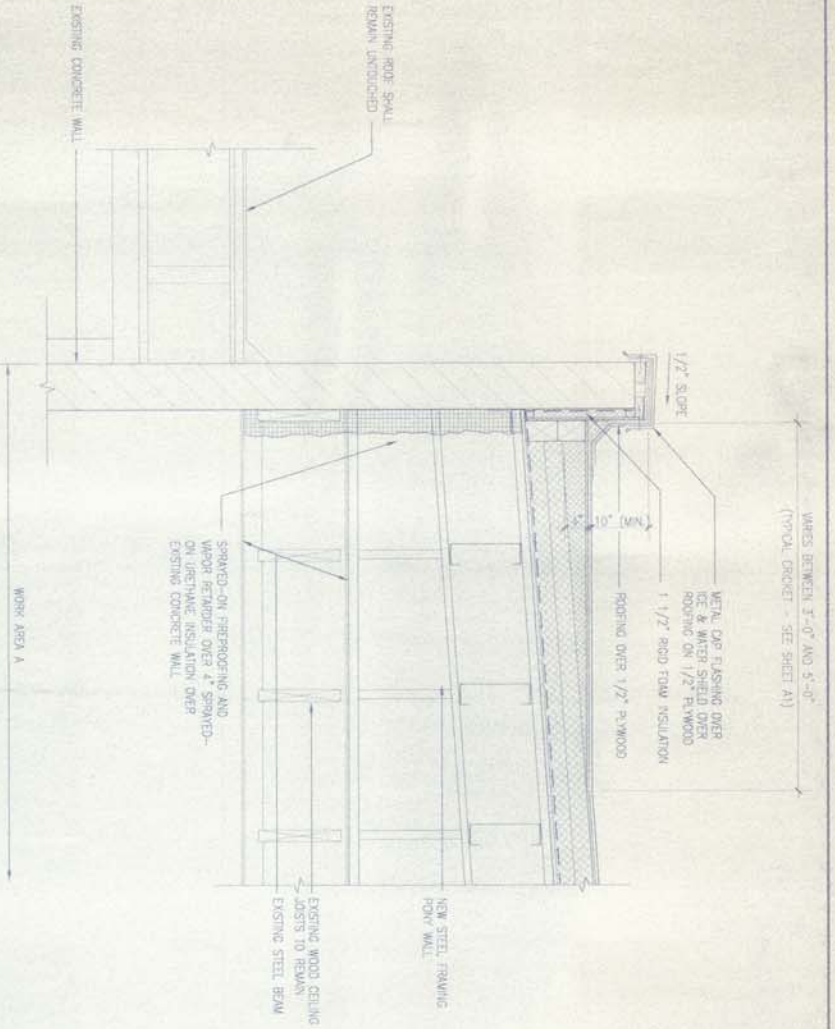

2 DETAIL
1/8" = 1'-0"

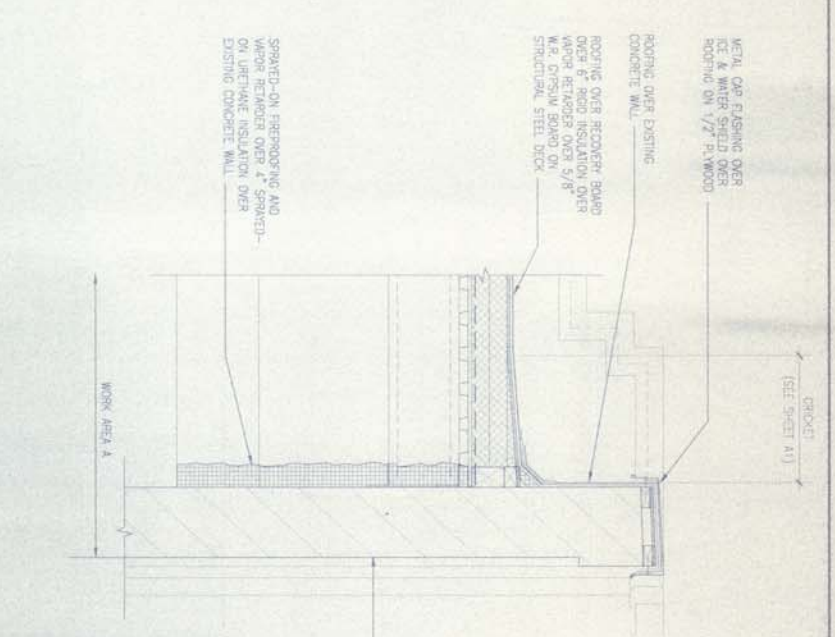

3 DETAIL
1/8" = 1'-0"

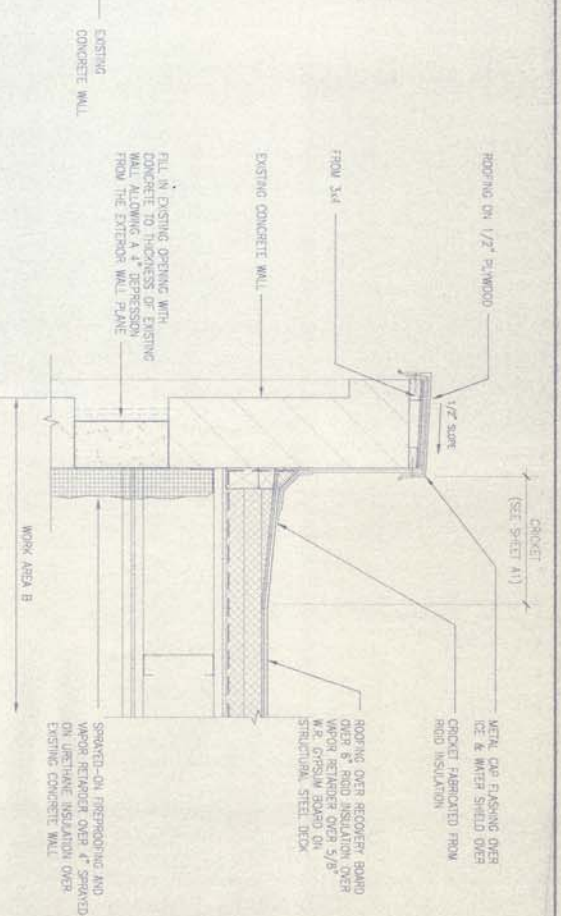

(A) BID FOR WORK AREAS A AND B TOGETHER

(B) BID FOR WORK AREA A ONLY

