



C. LEMARCHAND KENNEDY AND ASSOCIATES:
enviromdesign
 ARCHITECTURE, PLANNING, ENERGY MANAGEMENT
 1327 KALAKAKET, FAIRBANKS, ALASKA 99701 (907) 479-3193

REVISIONS:

PROJECT NO.
 DATE: JULY 2, 1986
 DRAWN: RJJ
 CHECKED: RBB

CONTENTS:
 POWER PLAN

SCALE: AS SHOWN

CITY OF FAIRBANKS
 SENIOR CITIZENS RECREATION
 AND NUTRITION CENTER ADDITION

DRAWING NO.

E2

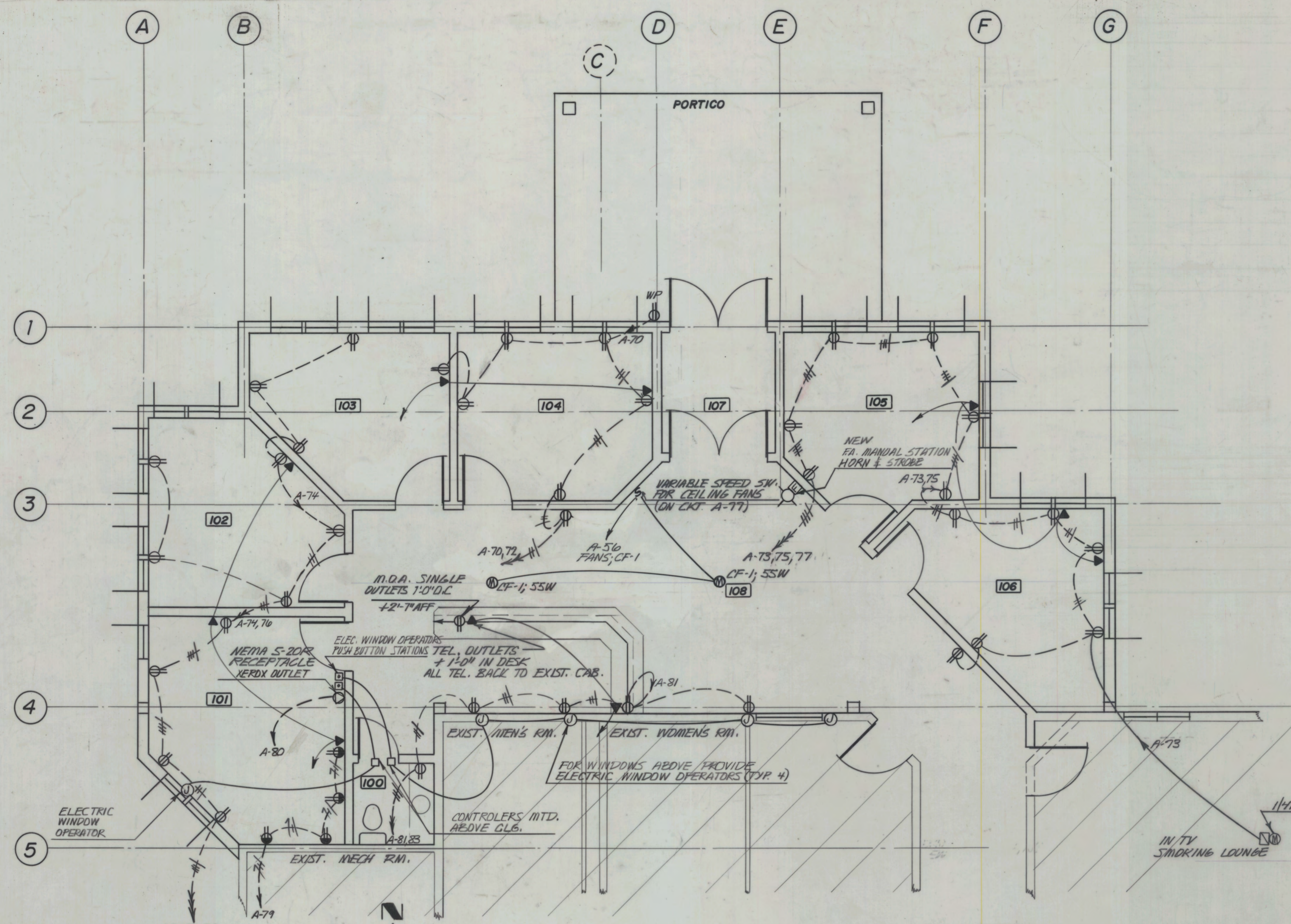

POWER PLAN
 SCALE 1/4" = 1'-0"

NOTES

1. TV OUTLET TO CONSIST OF A 4S BOX WITH SINGLE GANG RING AND BLANK PLATE. INSTALL ONE 3/4 INCH EMT FROM BOX TO ACCESSIBLE POINT IN ROOF TRUSSES. INSTALL FULL CORD AND CLEARLY MARK TERMINATION POINT ON THE AS-BUILT DRAWINGS.
2. WIRING IS TO BE CONCEALED. WHERE WIRING FROM ROOM 110 CROSSES THE KITCHEN AND CORRIDOR TO THE MECHANICAL ROOM (PANEL A) WIRE IN SURFACE EMT IN THE KITCHEN AND IN SURFACE METAL RACEWAY IN THE CORRIDOR.
3. WIRE A MAXIMUM OF THREE TELEPHONE OUTLETS IN 3/4 INCH EMT TO THE TELEPHONE CABINET LOCATED IN THE JANITORS CLOSET ADJACENT TO THE MECHANICAL. INSTALL A FULL CORD IN EACH RUN.

RECORD DRAWING
 THIS RECORD DRAWING HAS BEEN PREPARED FROM INFORMATION FURNISHED BY THE CONSTRUCTION CONTRACTOR AND THE ACCURACY AND COMPLETENESS OF SUCH INFORMATION IS NOT GUARANTEED.
 LAKE & BOSWELL, CONSULTING ELECTRICAL ENGINEERS, INC.

