

CITY OF FAIRBANKS  
ENGINEERING DEPARTMENT

PROPOSED HIGHWAY PROJECT  
ITB 18-12  
TRANSVERSE PAVEMENT MARKINGS

INDEX OF SHEETS	
SHEET NO.	DESCRIPTION
1.01	TITLE SHEET
2.01	ESTIMATE OF QUANTITIES AND SUMMARY
3.01	INDEX SHEET
3.02-3.16	PROJECT LAYOUTS & STRIPING SUMMARY

THE FOLLOWING STANDARD DRAWINGS APPLY TO THIS PROJECT:  
T-20.03, T-21.03, T-22.03, T-23.00

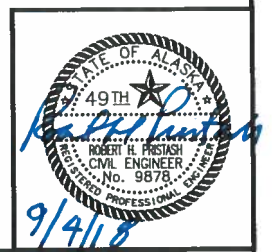
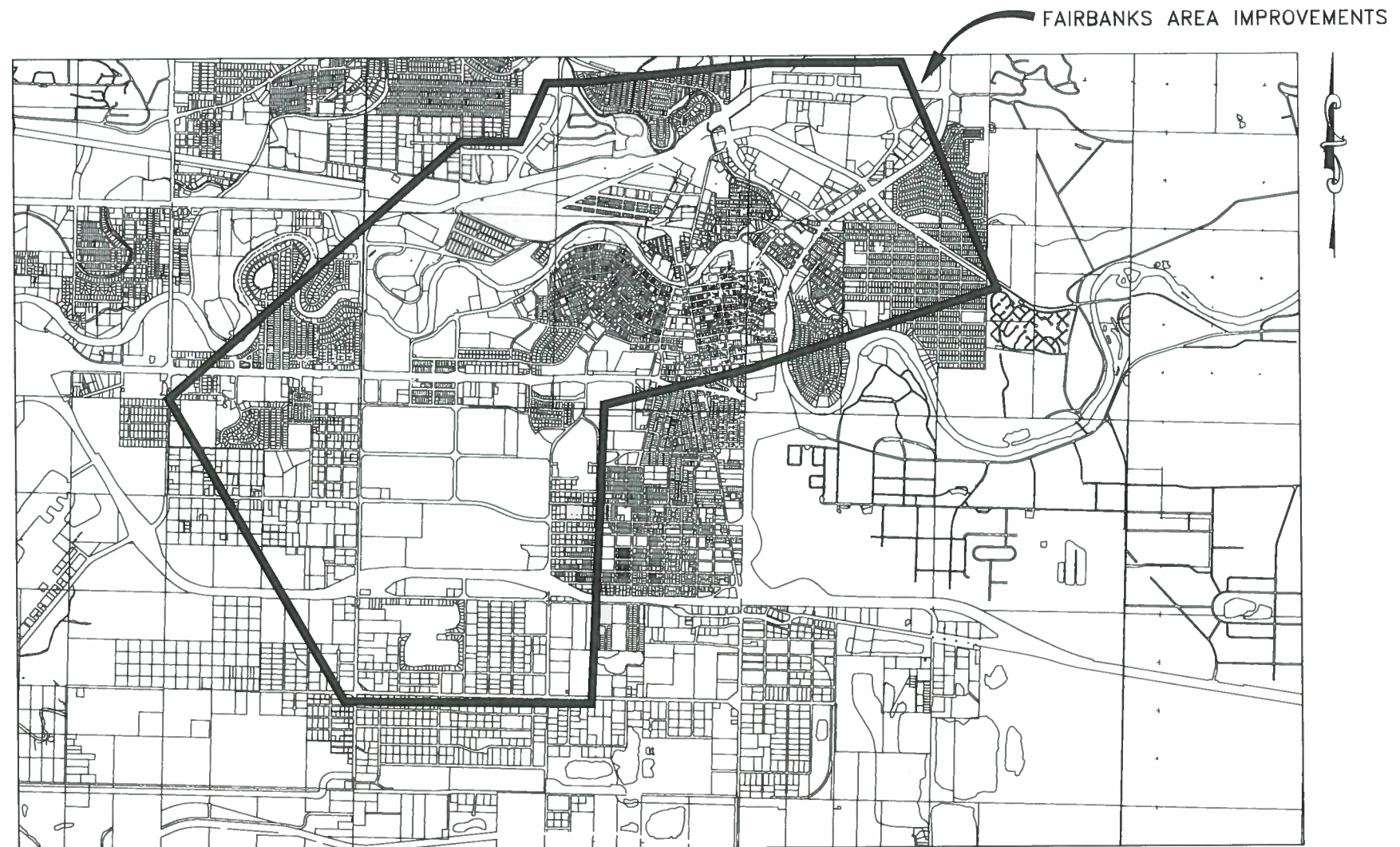

DATE	REVISION	BY

SCALE: NONE

DESIGNED: C.O.F. STAFF  
DRAWN: C.O.F. STAFF  
CHECKED: R.H.P.  
DATE: 08/27/18

APPROVED  
CITY ENGINEER  
DATE

Transverse Pavement Markings

CITY OF FAIRBANKS, ALASKA  
Engineering Department  
Project ITB-18-12

1.01  
OF 18  
SHEETS

**ESTIMATE OF QUANTITIES**

ITEM NO.	PAY ITEM	PAY UNIT	QUANTITY
643(2)	TRAFFIC MAINTENANCE	LUMP SUM	ALL REQUIRED
670(1-A)	PAINTED TRAFFIC MARKINGS - ARROW	EACH	212
670(1-B)	PAINTED TRAFFIC MARKINGS - 18 INCH DIAGONAL ISLAND STRIPING - YELLOW	SQUARE FOOT	1784
670(1-C)	PAINTED TRAFFIC MARKINGS - 18 INCH DIAGONAL ISLAND STRIPING - WHITE	SQUARE FOOT	186
670(1-D)	PAINTED TRAFFIC MARKINGS - SPEED HUMP	EACH	110
670(1-E)	PAINTED TRAFFIC MARKINGS - 24 INCH STANDARD CROSSWALKS	SQUARE FOOT	11438
670(1-F)	PAINTED TRAFFIC MARKINGS - 24 INCH STOP BAR	SQUARE FOOT	1608

**ESTIMATE OF QUANTITIES - ALTERNATE**

ITEM NO.	PAY ITEM	PAY UNIT	QUANTITY
643(2)	TRAFFIC MAINTENANCE	LUMP SUM	ALL REQUIRED
670(1-G)	MMA PAVEMENT MARKINGS ARROW INLAID	EACH	212
670(1-H)	MMA PAVEMENT MARKINGS 18 INCH DIAGONAL ISLAND STRIPING YELLOW INLAID	SQUARE FOOT	1784
670(1-J)	MMA PAVEMENT MARKINGS 18 INCH DIAGONAL ISLAND STRIPING WHITE INLAID	SQUARE FOOT	186
670(1-K)	MMA PAVEMENT MARKINGS SPEED HUMP INLAID	EACH	110
670(1-L)	MMA PAVEMENT MARKINGS 24 INCH STANDARD CROSSWALKS INLAID	SQUARE FOOT	11438
670(1-M)	MMA PAVEMENT MARKINGS 24 INCH STOP BAR INLAID	SQUARE FOOT	1608

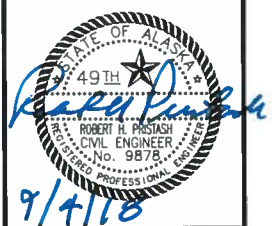

Tue, 04/Sep/18 02:38pm

DATE	REVISION	BY	SCALE: NONE	DESIGNED: C.O.F. STAFF DRAWN: C.O.F. STAFF CHECKED: R.H.P. DATE: 08/27/18	APPROVED _____ CITY ENGINEER DATE	<b>Transverse Pavement Markings</b>	CITY OF FAIRBANKS, ALASKA Engineering Department Project ITB-18-12	2.01 OF 18 SHEETS
------	----------	----	-------------	--	--	-------------------------------------	--	-------------------------

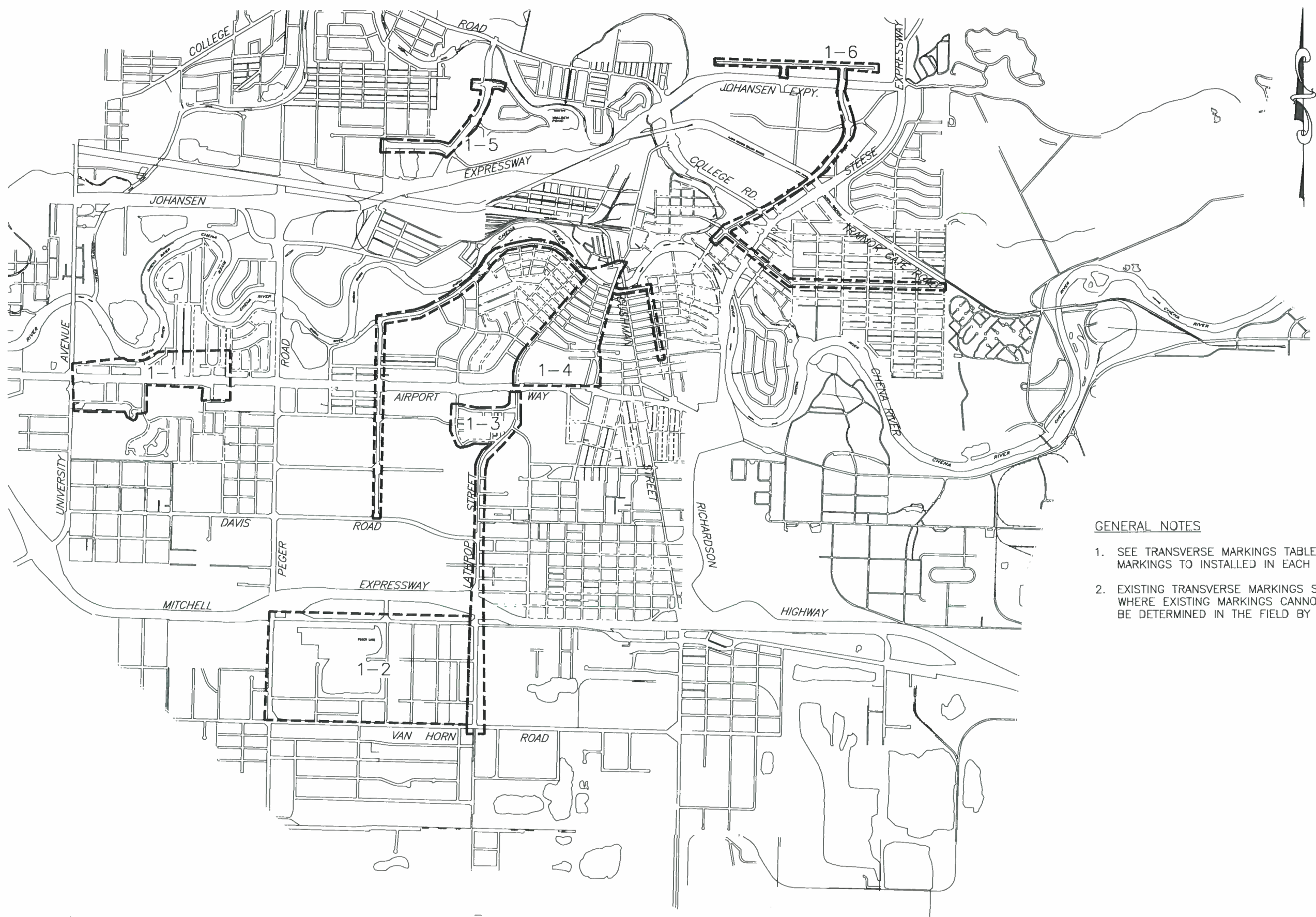

**GENERAL NOTES**

1. SEE TRANSVERSE MARKINGS TABLE SHEETS FOR LIST OF MARKINGS TO INSTALLED IN EACH AREA.
2. EXISTING TRANSVERSE MARKINGS SHALL BE USED FOR LAYOUT. WHERE EXISTING MARKINGS CANNOT BE FOUND, LOCATION TO BE DETERMINED IN THE FIELD BY ENGINEER.

DATE	REVISION	BY

SCALE: NONE

DESIGNED: C.O.F. STAFF  
 DRAWN: C.O.F. STAFF  
 CHECKED: R.H.P.  
 DATE: 08/27/18

APPROVED  
 \_\_\_\_\_  
 CITY ENGINEER  
 DATE

**Transverse Pavement Markings**

CITY OF FAIRBANKS, ALASKA  
 Engineering Department  
 Project ITB-18-12

3.01  
 OF 18  
 SHEETS

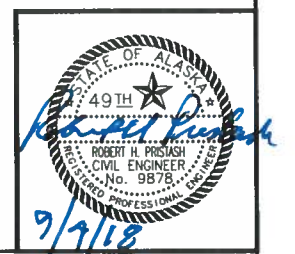

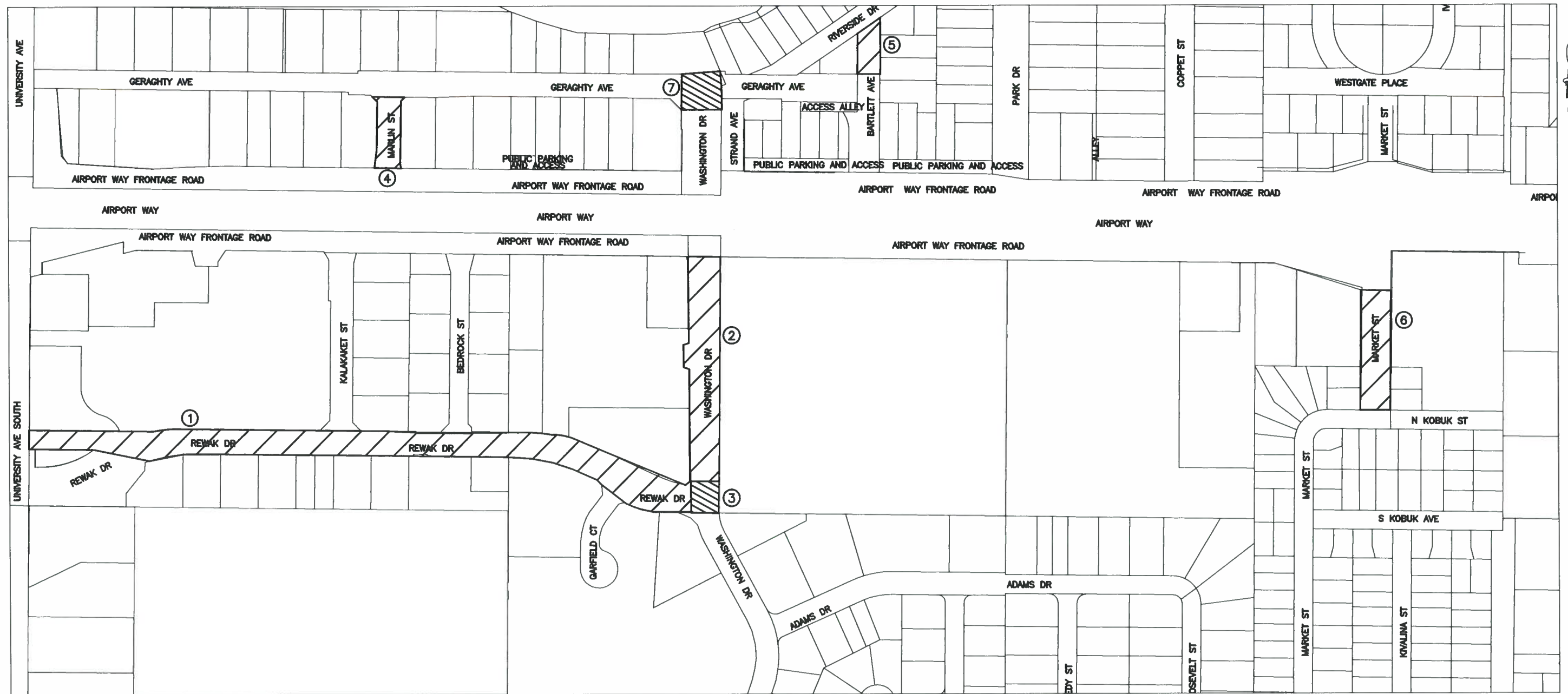

FAIRBANKS AREA 1-1

SEE SHEET 3.03 FOR ADDITIONAL PAINTED TRANSVERSE MARKING DETAILS

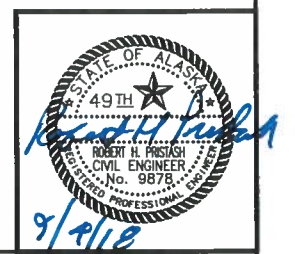

DATE	REVISION	BY

SCALE: NONE

DESIGNED: C.O.F. STAFF  
 DRAWN: C.O.F. STAFF  
 CHECKED: R.H.P.  
 DATE: 08/27/18

APPROVED  
 \_\_\_\_\_  
 CITY ENGINEER  
 DATE

Transverse Pavement Markings

CITY OF FAIRBANKS, ALASKA  
 Engineering Department  
 Project ITB-18-12

3.02  
 OF 18  
 SHEETS

NO.	PAVEMENT MARKING TYPE	PRIMARY STREET	SECONDARY STREET	CARDINAL DIRECTION	24" CROSSWALKS (EACH)	24" CROSSWALKS (LF)	24" STANDARD CROSSWALKS (SF)	RIGHT/LEFT ARROWS (EACH)	18" DIAGONAL ISLAND STRIPING - YELLOW (EACH)	18" DIAGONAL ISLAND STRIPING - YELLOW (LF)	18" DIAGONAL ISLAND STRIPING - YELLOW (SF)	24" WHITE STOP BAR (EACH)	24" WHITE STOP BAR (LF)	24" WHITE STOP BAR (SF)	LOCATION GUIDELINES	
①	Paint	Rwak Drive		-	2	162	324	0	2	260	390	1	14	28	University Avenue to Washington Drive	
②	Paint	Washington Drive		-	0	0	0	2	0	0	0	1	27	54	Airport Road to Adams Drive	
③	Paint	Rwak Drive	Washington Drive	North Leg	0	0	0	3	0	0	0	1	40	80	East leg of intersection no longer maintained	
				South Leg	1	90	180	0	0	0	0	0	0	0		
				West Leg	1	109	218	2	0	0	0	0	0	0		
				East Leg	-	-	-	-	-	-	-	-	-	-		
				Intersection Total	2	199	398	5	0	0	0	1	40	80		
④	Paint	Marlin Street		-	0	0	0	0	0	0	1	17	34	Airport Way to Geraghty Avenue		
⑤	Paint	Bartlett Drive		-	0	0	0	0	0	0	1	12	24	Geraghty Avenue to Riverside Drive		
⑥	Paint	Market Street		-	0	0	0	1	0	0	0	0	0	Airport Frontage Road to N. Kobuk Avenue		
⑦	Paint	Geraghty Avenue	Strand Drive	North Leg	-	-	-	-	-	-	-	-	-	-		
				South Leg	0	0	0	4	0	0	0	0	0	0		
				West Leg	0	0	0	0	0	0	0	0	1	18		36
				East Leg	0	0	0	0	0	0	0	0	1	20		40
				Intersection Total	0	0	0	4	0	0	0	2	38	76		
TOTAL:					6	560	1120	21	2	260	390	10	226	452		

FAIRBANKS AREA 1-1

SEE SHEET 3.02 FOR GENERAL STREET LOCATION

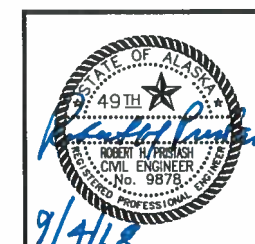

DATE	REVISION	BY

SCALE: NONE

DESIGNED: C.O.F. STAFF  
DRAWN: C.O.F. STAFF  
CHECKED: R.H.P.  
DATE: 08/27/18

APPROVED  
\_\_\_\_\_  
CITY ENGINEER  
DATE

Transverse Pavement Markings

CITY OF FAIRBANKS, ALASKA  
Engineering Department  
Project ITB-18-12

3.03  
OF 18 SHEETS

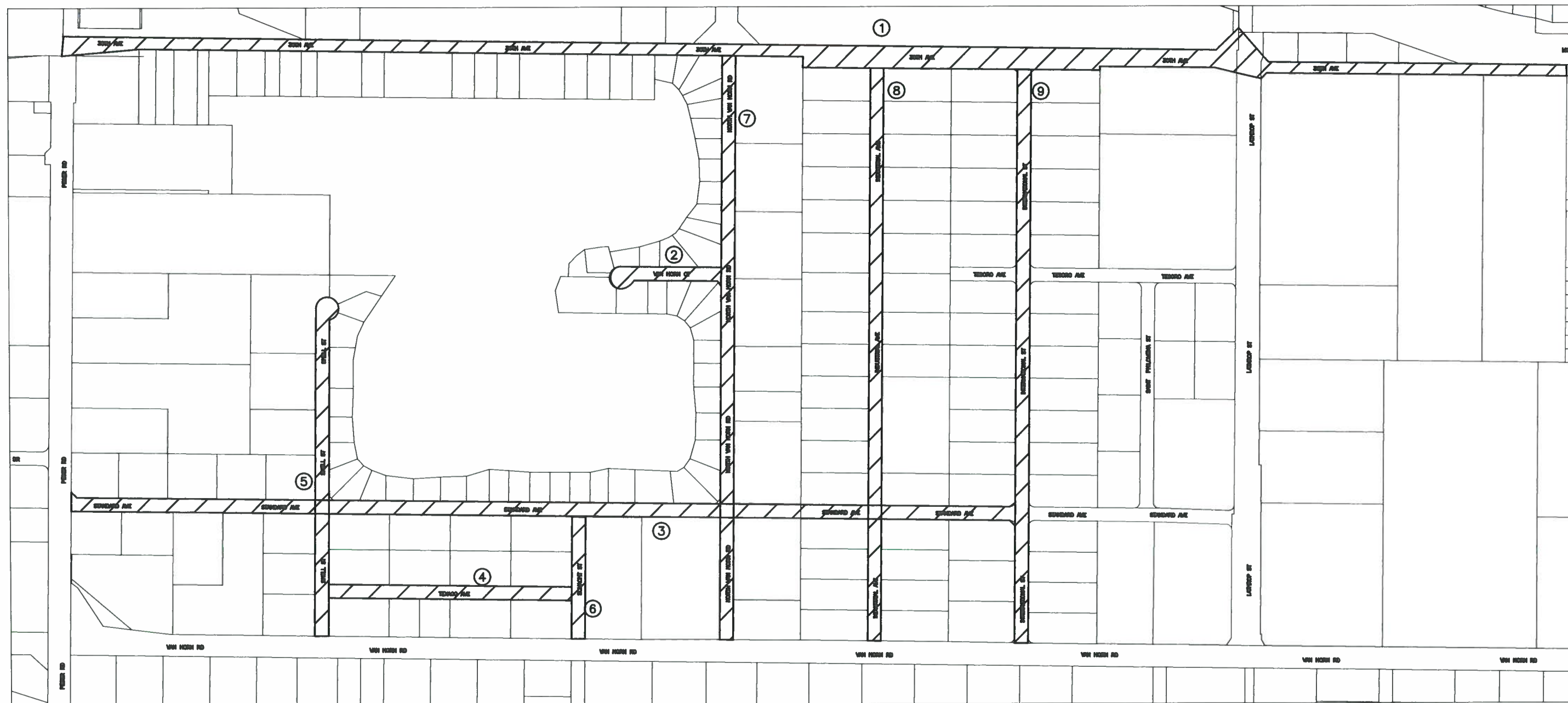

FAIRBANKS AREA 1-2

SEE SHEET 3.05 FOR ADDITIONAL PAINTED TRANSVERSE MARKING DETAILS

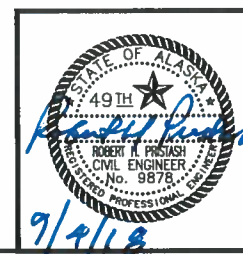

DATE	REVISION	BY

SCALE: NONE

DESIGNED: C.O.F. STAFF  
 DRAWN: C.O.F. STAFF  
 CHECKED: R.H.P.  
 DATE: 08/27/18

APPROVED  
 \_\_\_\_\_  
 CITY ENGINEER  
 DATE

Transverse Pavement Markings

CITY OF FAIRBANKS, ALASKA  
 Engineering Department  
 Project ITB-18-12

3.04  
 OF 18  
 SHEETS

NO.	PAVEMENT MARKING TYPE	PRIMARY STREET	SECONDARY STREET	18" DIAGONAL ISLAND STRIPING - YELLOW (EACH)	18" DIAGONAL ISLAND STRIPING - YELLOW (LF)	18" DIAGONAL ISLAND STRIPING - YELLOW (SF)	24" WHITE STOP BAR (EACH)	24" WHITE STOP BAR (LF)	24" WHITE STOP BAR (SF)	LOCATION GUIDELINES
①	Paint	30th Avenue		1	188	282	1	25	50	Peger Road to Old Richardson Highway
②	Paint	Vanhorn Court		0	0	0	1	17	34	N. Vanhorn Street to Dead End
③	Paint	Standard Avenue		0	0	0	5	87	174	Peger Road to International
④	Paint	Texaco Avenue		0	0	0	2	32	64	Shell Street to Schacht Street
⑤	Paint	Shell Street		0	0	0	3	50	100	Vanhorn Road to Dead End
⑥	Paint	Schacht Street		0	0	0	1	19	38	Standard Avenue to Vanhorn Road
⑦	Paint	N. Vanhorn Street		0	0	0	3	53	106	30th Avenue to Vanhorn Road
⑧	Paint	Industrial Avenue		0	0	0	1	20	40	31st Avenue to Vanhorn Road
⑨	Paint	International Street		0	0	0	1	22	44	32nd Avenue to Vanhorn Road
TOTAL:				1	188	282	18	325	650	

**FAIRBANKS AREA 1-2**

SEE SHEET 3.04 FOR GENERAL STREET LOCATION

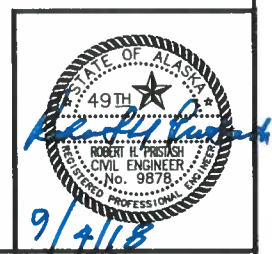

DATE	REVISION	BY

SCALE: NONE

DESIGNED: C.O.F. STAFF  
DRAWN: C.O.F. STAFF  
CHECKED: R.H.P.  
DATE: 08/27/18

APPROVED  
\_\_\_\_\_  
CITY ENGINEER  
DATE

**Transverse Pavement Markings**

CITY OF FAIRBANKS, ALASKA  
Engineering Department  
Project ITB-18-12

**3.05**  
OF 18  
SHEETS

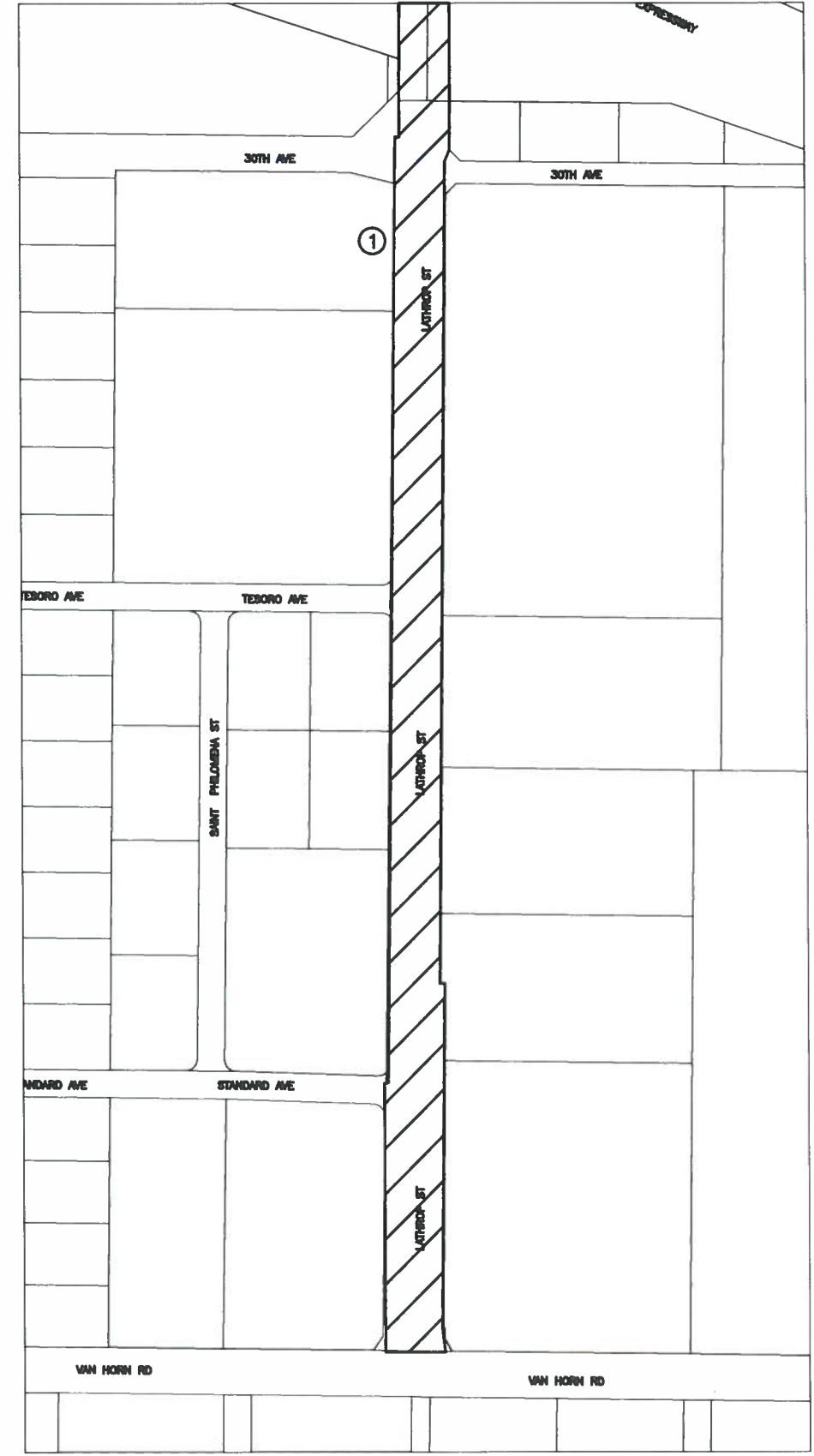
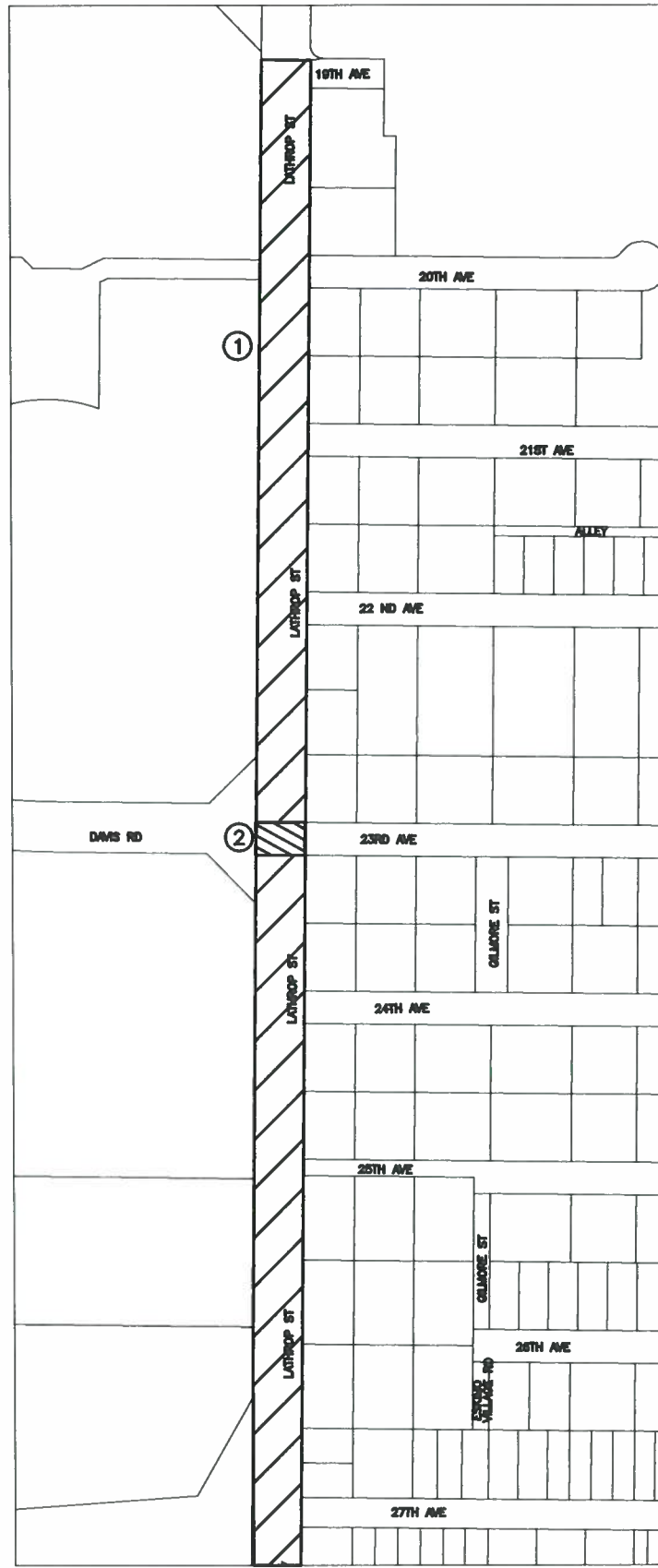
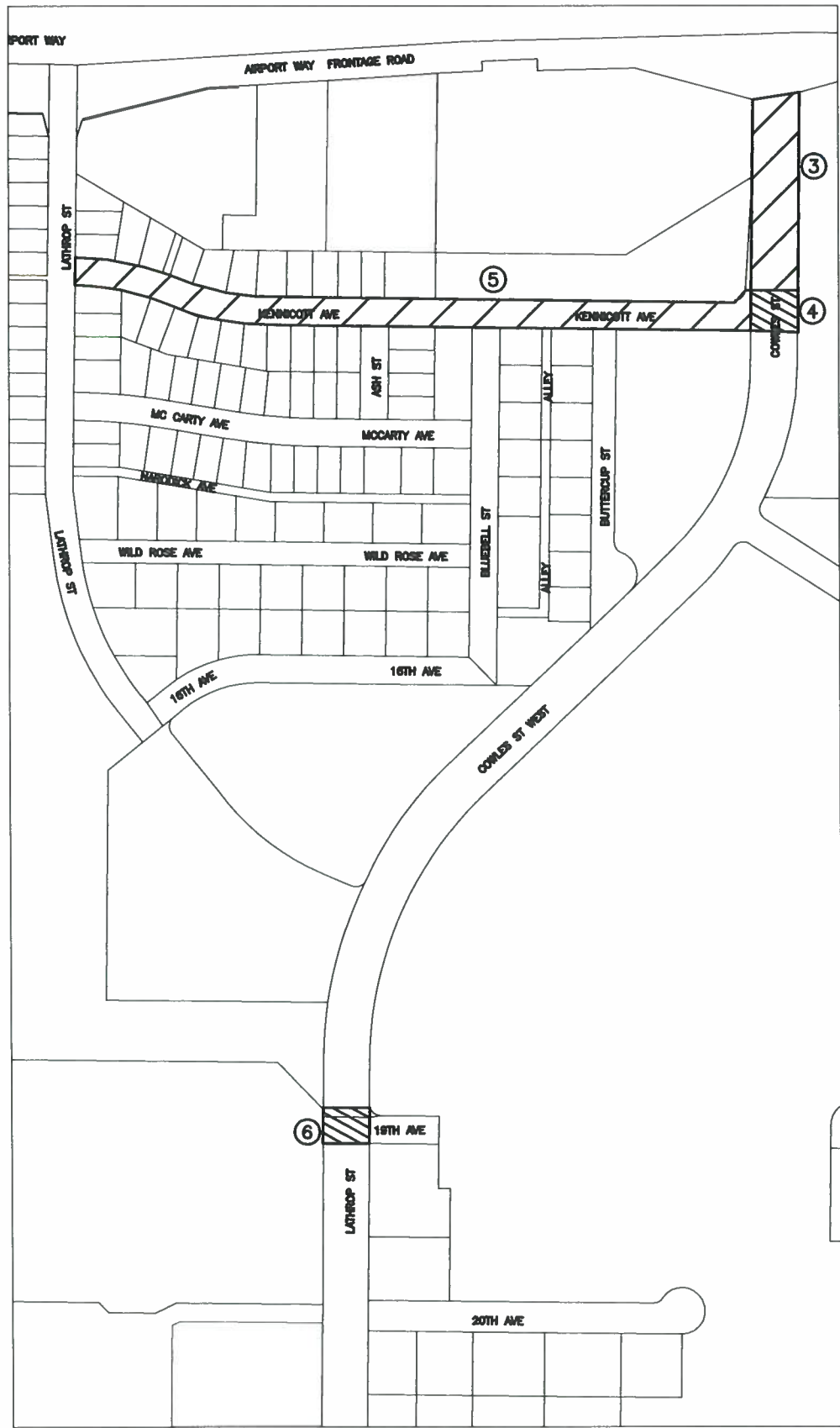

FAIRBANKS AREA 1-3

SEE SHEET 3.07 FOR ADDITIONAL PAINTED TRANSVERSE MARKING DETAILS

DATE	REVISION	BY

SCALE: NONE

DESIGNED: C.O.F. STAFF  
 DRAWN: C.O.F. STAFF  
 CHECKED: R.H.P.  
 DATE: 08/27/18

APPROVED  
 \_\_\_\_\_  
 CITY ENGINEER  
 DATE

Transverse Pavement Markings

CITY OF FAIRBANKS, ALASKA  
 Engineering Department  
 Project ITB-18-12

3.06  
 OF 18  
 SHEETS





NO.	PAVEMENT MARKING TYPE	PRIMARY STREET	SECONDARY STREET	CARDINAL DIRECTION	24" CROSSWALKS (EACH)	24" CROSSWALKS (LF)	24" STANDARD CROSSWALKS (SF)	RIGHT/LEFT ARROWS (EACH)	18" DIAGONAL ISLAND STRIPING - YELLOW (EACH)	18" DIAGONAL ISLAND STRIPING - YELLOW (LF)	18" DIAGONAL ISLAND STRIPING - YELLOW (SF)	LOCATION GUIDELINES
①	Paint	South Lathrop Street		-	0	0	0	26	2	272	408	19th Avenue to Vanhorn Road
②	Paint	Lathrop Street	23rd Avenue	North Leg	1	116	232	2	0	0	0	
				South Leg	1	128	256	2	0	0		
				West Leg	-	-	-	-	-	-		
				East Leg	1	107	214	2	0	0		
				Intersection Total	3	351	702	6	0	0		
③	Paint	West Cowles		-	0	0	0	8	0	0	0	Kennicott Avenue to Airport Way
④	Inlaid MMA	Cowles Street	Kennicott Avenue	North Leg	1	151	302	3	0	0	0	
	Inlaid MMA			South Leg	1	145	290	1	0	0		
	Inlaid MMA			West Leg	1	102	204	2	0	0		
	Paint			East Leg	1	116	232	1	0	0		
	-			Intersection Total	4	514	1028	7	0	0		
⑤	Paint	Kennicott Avenue		-	0	0	0	4	0	0	0	Lathrop Street to Cowles Street
⑥	Paint	East Cowles Street	17th/19th Avenue	North Leg	0	0	0	0	0	0	0	
	Paint			South Leg	0	0	0	0	0	0		
	Paint			East Leg	0	0	0	2	0	0		
	-			Intersection Total	0	0	0	2	0	0		
TOTAL:					7	865	1730	53	2	272	408	

FAIRBANKS AREA 1-3

SEE SHEET 3.06 FOR GENERAL STREET LOCATION

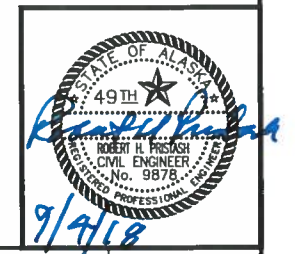

DATE	REVISION	BY

SCALE: NONE

DESIGNED: C.O.F. STAFF  
 DRAWN: C.O.F. STAFF  
 CHECKED: R.H.P.  
 DATE: 08/27/18

APPROVED \_\_\_\_\_  
 CITY ENGINEER  
 DATE \_\_\_\_\_

Transverse Pavement Markings

CITY OF FAIRBANKS, ALASKA  
 Engineering Department  
 Project ITB-18-12

3.07  
 OF 18 SHEETS

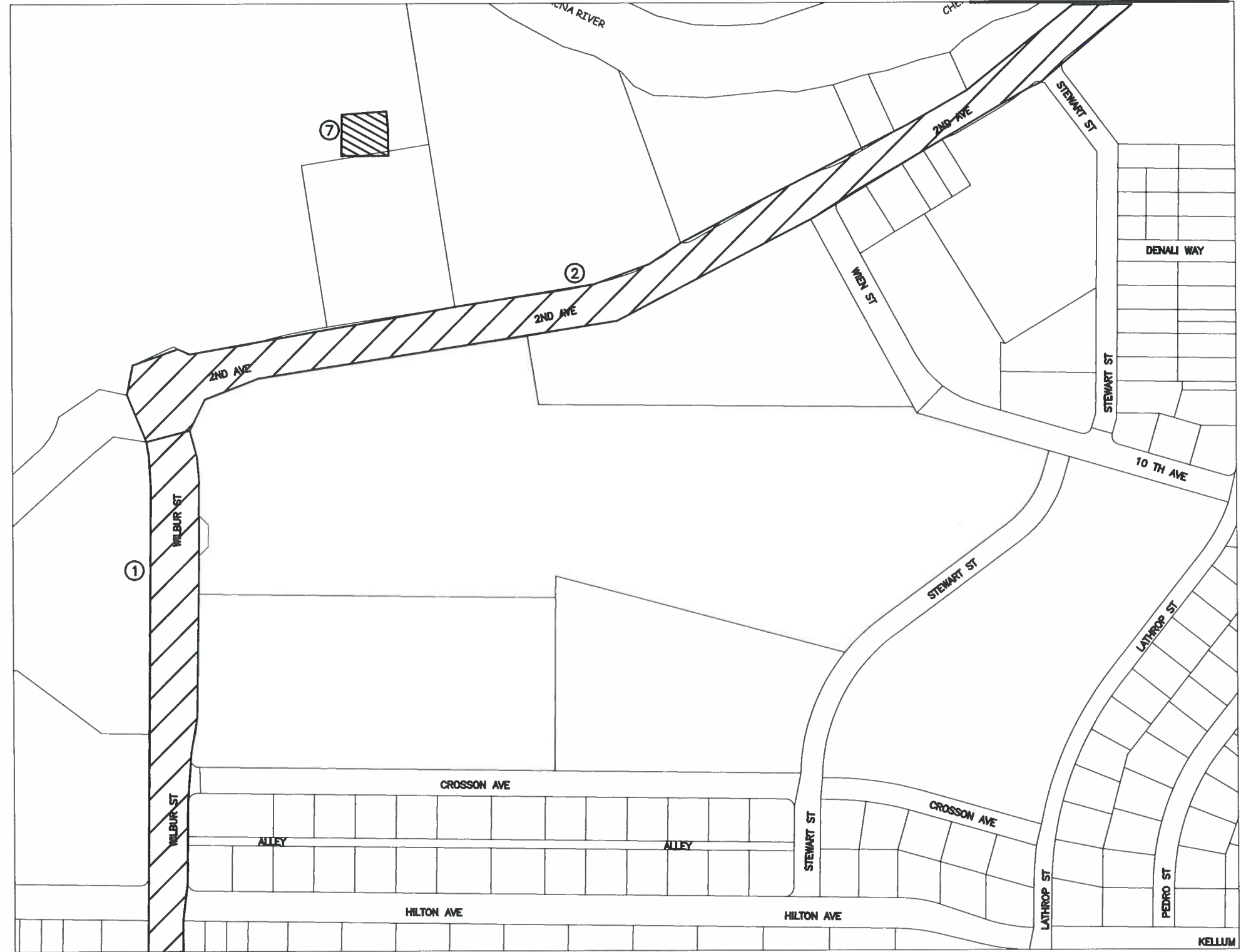
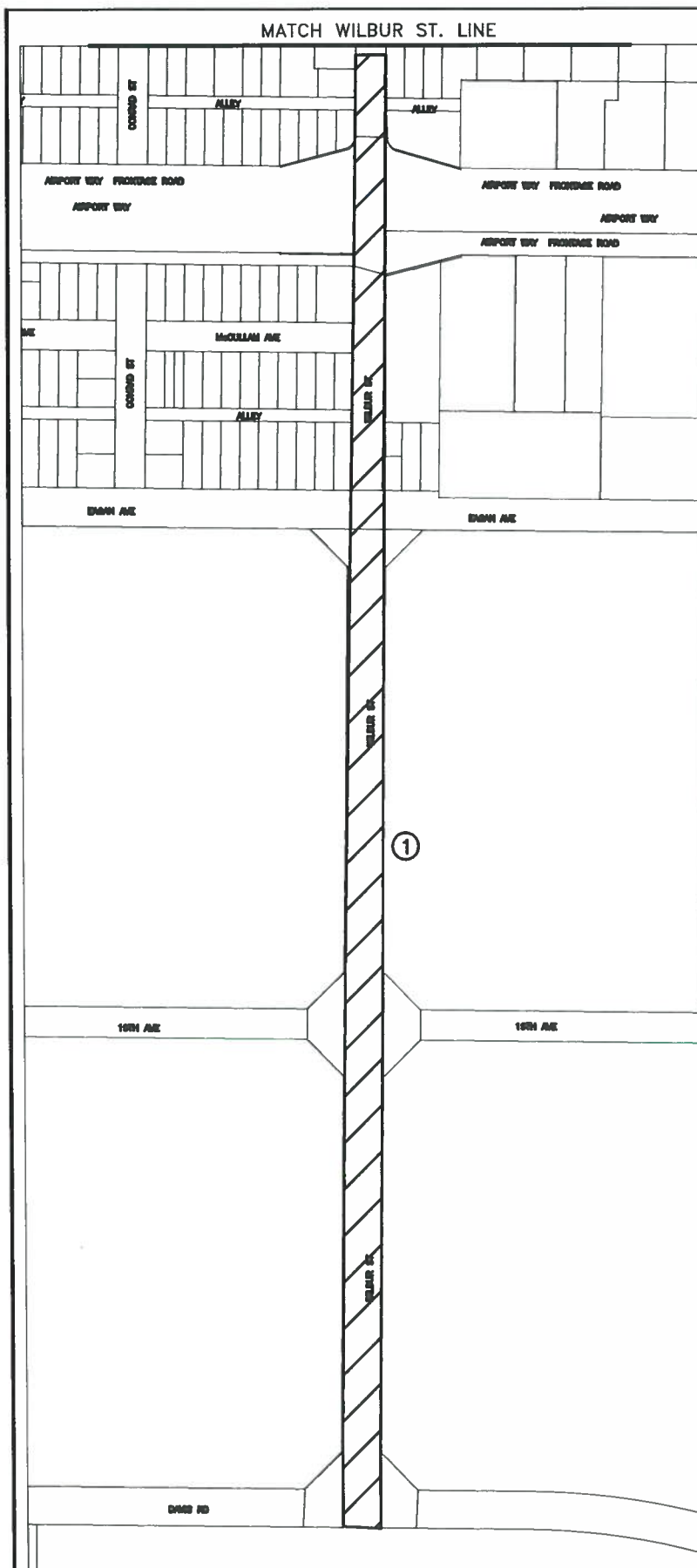

MATCH WILBUR ST. LINE

FAIRBANKS AREA 1-4

SEE SHEET 3.10 FOR ADDITIONAL PAINTED TRANSVERSE MARKING DETAILS

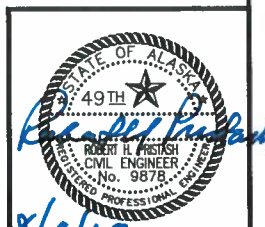

DATE	REVISION	BY

SCALE: NONE

DESIGNED: C.O.F. STAFF  
 DRAWN: C.O.F. STAFF  
 CHECKED: R.H.P.  
 DATE: 08/27/18

APPROVED  
 \_\_\_\_\_  
 CITY ENGINEER  
 DATE

Transverse Pavement Markings

CITY OF FAIRBANKS, ALASKA  
 Engineering Department  
 Project ITB-18-12

3.08  
 OF 18  
 SHEETS



FAIRBANKS AREA 1-4

SEE SHEET 3.10 FOR ADDITIONAL PAINTED TRANSVERSE MARKING DETAILS

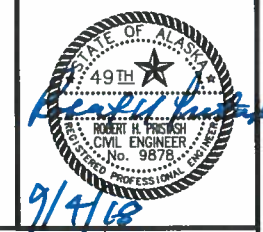

DATE	REVISION	BY

SCALE: NONE

DESIGNED: C.O.F. STAFF	APPROVED
DRAWN: C.O.F. STAFF	_____
CHECKED: R.H.P.	CITY ENGINEER
DATE: 08/27/18	DATE

Transverse Pavement Markings

CITY OF FAIRBANKS, ALASKA  
Engineering Department  
Project ITB-18-12

3.09  
OF 18  
SHEETS



**FAIRBANKS AREA 1-4**

SEE SHEET 3.10 FOR ADDITIONAL PAINTED TRANSVERSE MARKING DETAILS

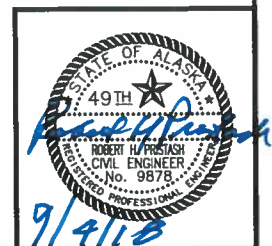

DATE	REVISION	BY

SCALE: NONE

DESIGNED: C.O.F. STAFF  
 DRAWN: C.O.F. STAFF  
 CHECKED: R.H.P.  
 DATE: 08/27/18

APPROVED  
 \_\_\_\_\_  
 CITY ENGINEER  
 DATE

**Transverse Pavement Markings**

CITY OF FAIRBANKS, ALASKA  
 Engineering Department  
 Project ITB-18-12

**3.10**  
 OF 18  
 SHEETS

NO.	PAVEMENT MARKING TYPE	PRIMARY STREET	SECONDARY STREET	CARDINAL DIRECTION	24" CROSSWALKS (EACH)	24" CROSSWALKS (LF)	24" STANDARD CROSSWALKS (SF)	RIGHT/LEFT ARROWS (EACH)	STRAIGHT ARROW (EACH)	COMBINATION ARROW (EACH)	18" DIAGONAL ISLAND STRIPING - YELLOW (EACH)	18" DIAGONAL ISLAND STRIPING - YELLOW (LF)	18" DIAGONAL ISLAND STRIPING - YELLOW (SF)	24" WHITE STOP BAR (EACH)	24" WHITE STOP BAR (LF)	24" WHITE STOP BAR (SF)	LOCATION GUIDELINES		
1	Paint	Wilbur Street		-	0	0	0	6	0	0	2	134	201	3	49	98	2nd Avenue to Davis Road		
2	Paint	2nd Avenue		-	0	0	0	1	0	0	2	161	241.5	0	0	0	Hilton Avenue to Grant Street		
3	Paint	Cowles Street		-	0	0	0	6	0	0	0	0	0	1	23	46	1st Avenue to Airport Way		
4	Paint	1st Avenue	Barnette Street	North Leg	1	80	160	3	0	0	0	0	0	0	0	0	0		
				South Leg	1	80	160	0	0	0	0	0	0	0	0	0	0		0
				West Leg	1	81	162	0	0	0	0	0	0	0	0	0	0		0
				East Leg	1	94	188	2	0	0	0	0	0	0	0	0	0		0
				Intersection Total	4	335	670	5	0	0	0	0	0	0	0	0	0		0
5	Paint	5th Avenue	Barnette Street	North Leg	1	84	168	0	0	0	0	0	0	0	0	0	0		
				South Leg	1	84	168	0	0	0	0	0	0	0	0	0	0		
				West Leg	1	87	174	0	0	0	0	0	0	0	0	0	0		
				East Leg	1	73	146	1	0	1	0	0	0	0	0	0	0		
				Intersection Total	4	328	656	1	0	1	0	0	0	0	0	0	0		
6	Paint	7th Avenue	Barnette Street	North Leg	1	88	176	0	0	0	0	0	0	0	0	0	0		
				South Leg	1	127	254	0	0	0	0	0	0	0	0	0	0		
				West Leg	1	87	174	0	0	0	0	0	0	0	0	0	0		
				East Leg	1	102	204	0	0	0	0	0	0	0	0	0	0		
				Intersection Total	4	404	808	0	0	0	0	0	0	0	0	0	0		
7	Paint	10th Avenue	Barnette Street	North Leg	1	97	194	0	0	0	0	0	0	0	0	0	0		
				South Leg	1	100	200	0	2	2	0	0	0	0	0	0	0		
				West Leg	1	80	160	1	0	0	0	0	0	0	0	0	0		
				East Leg	1	79	158	0	0	0	0	0	0	0	0	0	0		
				Intersection Total	4	356	712	1	2	2	0	0	0	0	0	0	0		
8	Paint	1st Avenue	Lacey Street	North Leg	1	54	108	0	0	0	0	0	0	0	0	0	0		
				South Leg	1	55	110	0	0	0	0	0	0	0	0	0	0		
				West Leg	1	106	212	0	0	0	0	0	0	0	0	0	0		
				East Leg	1	93	186	1	1	1	0	0	0	0	0	0	0		
				Intersection Total	4	308	616	1	1	1	0	0	0	0	0	0	0		
9	Paint	2nd Avenue	Lacey Street	North Leg	1	60	120	0	0	0	0	0	0	0	0	0	0		
				South Leg	1	66	132	0	0	0	0	0	0	0	0	0	0		
				West Leg	1	81	162	1	0	0	0	0	0	0	0	0	0		
				East Leg	1	80	160	0	0	0	0	0	0	0	0	0	0		
				Intersection Total	4	287	574	1	0	0	0	0	0	0	0	0	0		
10	Paint	3rd Avenue	Lacey Street	North Leg	1	71	142	0	0	0	0	0	0	0	0	0	0		
				South Leg	1	73	146	0	0	0	0	0	0	0	0	0	0		
				West Leg	1	52	104	0	0	0	0	0	0	0	0	0	0		
				East Leg	1	66	132	0	0	0	0	0	0	0	0	0	0		
				Intersection Total	4	262	524	0	0	0	0	0	0	0	0	0	0		
11	Paint	4th Avenue	Lacey Street	North Leg	1	65	130	0	0	0	0	0	0	0	0	0	0		
				South Leg	1	65	130	0	0	0	0	0	0	0	0	0	0		
				West Leg	1	68	136	1	0	1	0	0	0	0	0	0	0		
				East Leg	1	57	114	0	0	0	0	0	0	0	0	0	0		
				Intersection Total	4	255	510	1	0	1	0	0	0	0	0	0	0		
12	Paint	10th Avenue	Lacey Street	North Leg	1	77	154	0	0	0	0	0	0	0	0	0	0		
				South Leg	1	68	136	0	0	0	0	0	0	0	0	0	0		
				West Leg	1	91	182	1	0	0	0	0	0	0	0	0	0		
				East Leg	1	79	158	1	0	0	0	0	0	0	0	0	0		
				Intersection Total	4	315	630	2	0	0	0	0	0	0	0	0	0		
TOTAL					36	2850	5700	25	3	4	4	295	442.5	4	72	144			

FAIRBANKS AREA 1-4

SEE SHEETS 3.08, 3.09 & 3.10 FOR GENERAL STREET LOCATION

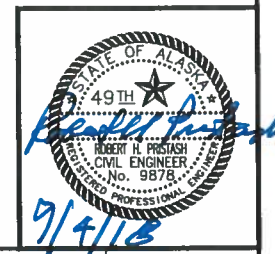

DATE	REVISION	BY

SCALE: NONE

DESIGNED: C.O.F. STAFF  
 DRAWN: C.O.F. STAFF  
 CHECKED: R.H.P.  
 DATE: 08/27/18

APPROVED  
 \_\_\_\_\_  
 CITY ENGINEER  
 DATE

Transverse Pavement Markings

CITY OF FAIRBANKS, ALASKA  
 Engineering Department

Project ITB-18-12

3.11

OF 18 SHEETS



**FAIRBANKS AREA 1-5**

SEE TABLE BELOW FOR ADDITIONAL PAINTED TRANSVERSE MARKING DETAILS

NO.	PAVEMENT MARKING TYPE	PRIMARY STREET	SECONDARY STREET	CARDINAL DIRECTION	24" CROSSWALKS (EACH)	24" CROSSWALKS (LF)	24" STANDARD CROSSWALKS (SF)	RIGHT/LEFT ARROWS (EACH)	LOCATION GUIDELINES
1	Paint	Wembley Avenue		-	0	0	0	4	Aurora Drive to Danby Street
2	Paint	Hampstead Avenue		-	2	220	440	0	Anne Wien Elem. School to
				TOTAL	2	220	440	4	

**FAIRBANKS AREA 1-5**

SEE ABOVE FOR GENERAL STREET LOCATION

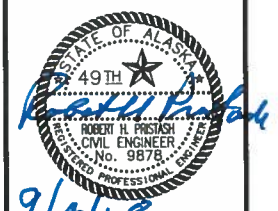

9/4/18

DATE	REVISION	BY

SCALE: NONE

DESIGNED: C.O.F. STAFF  
 DRAWN: C.O.F. STAFF  
 CHECKED: R.H.P.  
 DATE: 08/27/18

APPROVED  
 \_\_\_\_\_  
 CITY ENGINEER  
 DATE

**Transverse Pavement Markings**

CITY OF FAIRBANKS, ALASKA  
 Engineering Department  
 Project ITB-18-12

3.12  
 OF 18  
 SHEETS

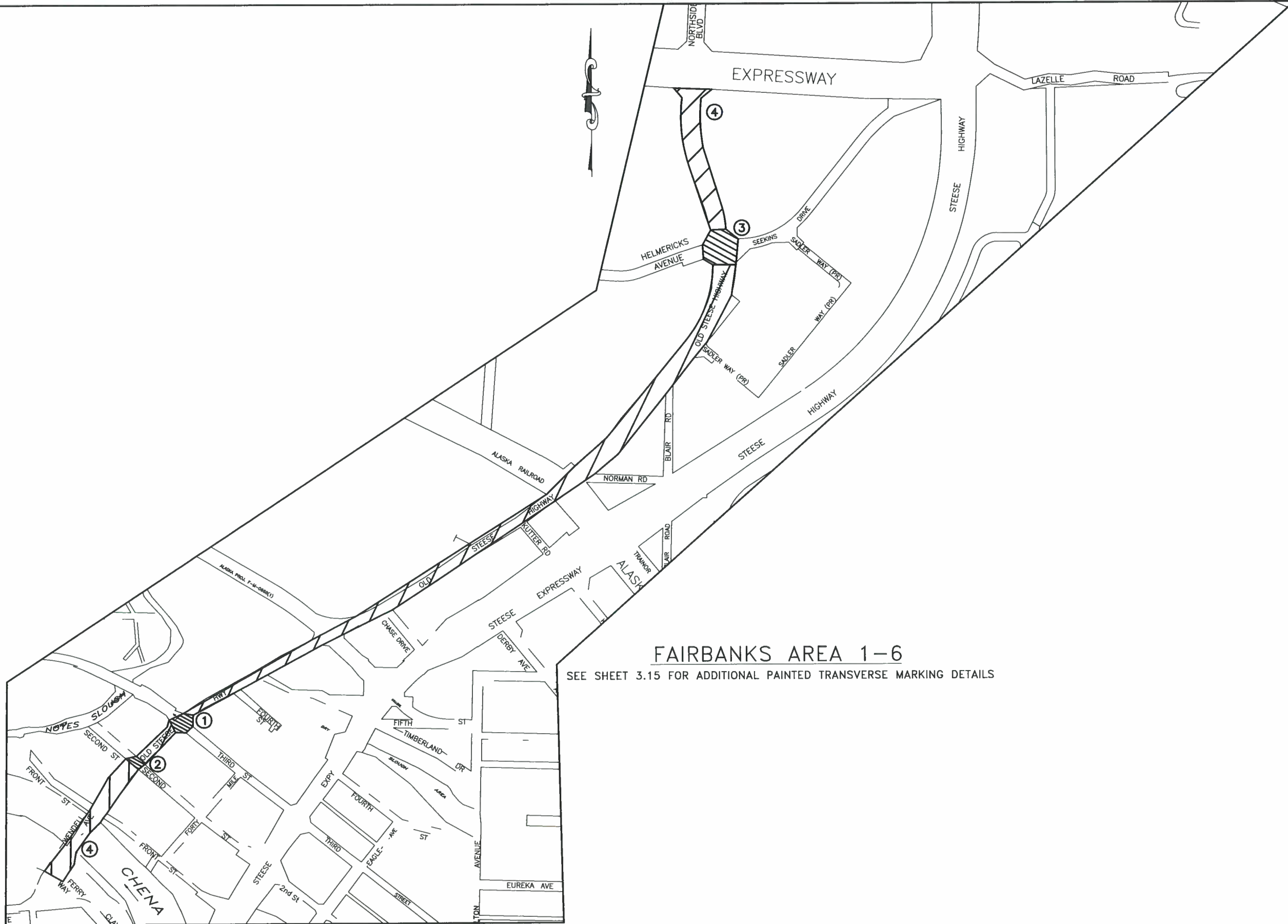

FAIRBANKS AREA 1-6

SEE SHEET 3.15 FOR ADDITIONAL PAINTED TRANSVERSE MARKING DETAILS

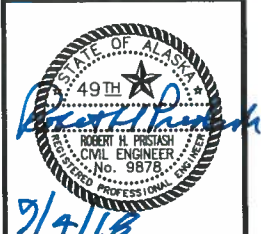

DATE	REVISION	BY

SCALE: NONE

DESIGNED: C.O.F. STAFF  
 DRAWN: C.O.F. STAFF  
 CHECKED: R.H.P.  
 DATE: 08/27/18

APPROVED  
 \_\_\_\_\_  
 CITY ENGINEER  
 DATE

Transverse Pavement Markings

CITY OF FAIRBANKS, ALASKA  
 Engineering Department  
 Project ITB-18-12

3.13  
 OF 18  
 SHEETS

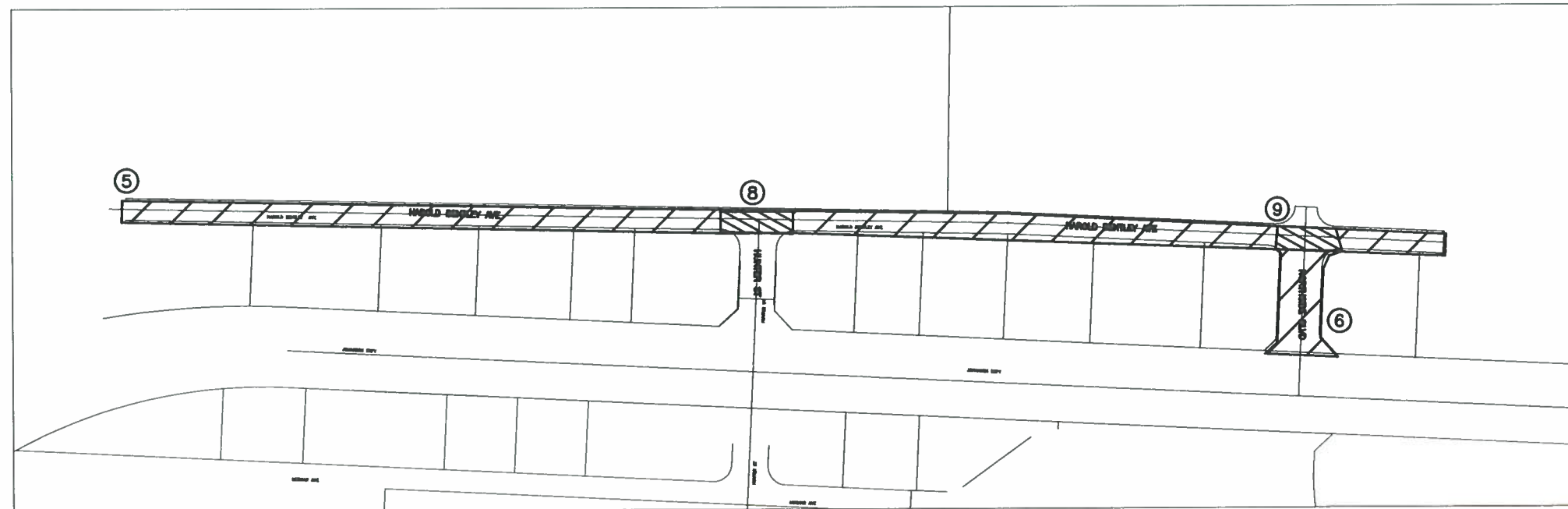
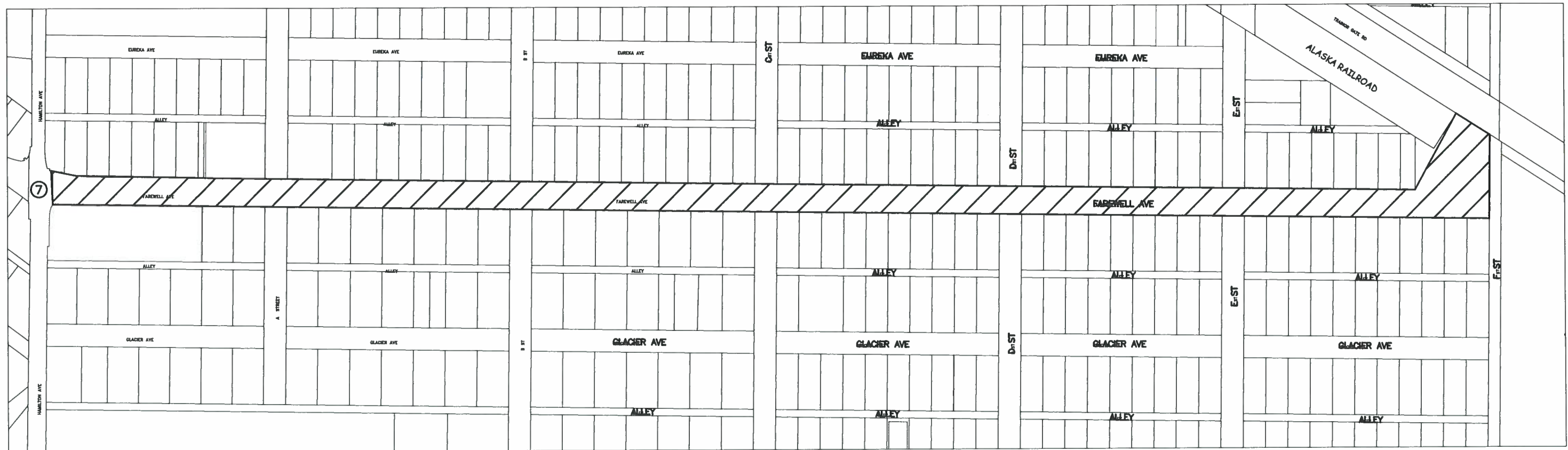

FAIRBANKS AREA 1-6

SEE SHEET 3.15 FOR ADDITIONAL PAINTED TRANSVERSE MARKING DETAILS

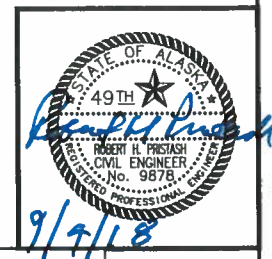

DATE	REVISION	BY

SCALE: NONE

DESIGNED: C.O.F. STAFF  
 DRAWN: C.O.F. STAFF  
 CHECKED: R.H.P.  
 DATE: 08/27/18

APPROVED  
 \_\_\_\_\_  
 CITY ENGINEER  
 DATE

Transverse Pavement Markings

CITY OF FAIRBANKS, ALASKA  
 Engineering Department  
 Project ITB-18-12

3.14  
 OF 18  
 SHEETS



NO.	PAVEMENT MARKING TYPE	PRIMARY STREET	SECONDARY STREET	CARDINAL DIRECTION	24" CROSSWALKS (EACH)	24" CROSSWALKS (LF)	24" STANDARD CROSSWALKS (SF)	RIGHT/LEFT ARROWS (EACH)	COMBINATION ARROW (EACH)	18" DIAGONAL ISLAND STRIPING - YELLOW (EACH)	18" DIAGONAL ISLAND STRIPING - YELLOW (LF)	18" DIAGONAL ISLAND STRIPING - YELLOW (SF)	24" WHITE STOP BAR (EACH)	24" WHITE STOP BAR (LF)	24" WHITE STOP BAR (SF)	LOCATION GUIDELINES
①	Paint	Minnic Street/3rd Street	Old Steese Highway	North Leg	1	153	306	1	1	0	0	0	0	0	0	
				South Leg	1	157	314	2	1	0	0	0	0	0		
				West Leg	1	137	274	2	0	0	0	0	0	0		
				East Leg	1	123	246	3	0	0	0	0	0	0		
				Intersection Total	4	570	1140	8	2	0	0	0	0	0		
②	Paint	Old Steese Highway	2nd Street (Play it Again Sports)	North Leg	0	0	0	1	0	0	0	0	0	0	0	
				South Leg	0	0	0	1	1	0	0	0	0	0		
				West Leg	0	0	0	1	0	0	0	1	42	84		
				East Leg	0	0	0	1	0	0	0	1	28	56		
				Intersection Total	0	0	0	4	1	0	0	2	70	140		
③	Paint	Helmericks Avenue	Old Steese Highway	North Leg	0	0	0	3	0	0	0	0	1	30	60	
				South Leg	1	197	394	2	0	0	0	0	0	0		
				West Leg	1	132	264	2	0	0	0	0	0	0		
				East Leg	1	147	294	2	0	1	62	93	0	0		
				Intersection Total	3	476	952	9	0	1	62	93	1	30	60	
④	Paint	Old Steese Highway		-	0	0	0	28	0	1	36	54	6	136	272	Johansen Expressway to Clay Street
⑤	Paint	Harold Bentley Avenue		-	0	0	0	16	0	0	0	0	0	0	0	Entire road (dead end to dead end)
⑥	Paint	Northside Blvd.		-	0	0	0	4	0	0	0	0	0	0	0	Johansen Expressway to Harold Bentley Avenue
⑦	Paint	Farewell Avenue		-	0	0	0	37	0	0	0	0	0	0	0	Trainor Gate Road to Hamilton Avenue
⑧	Paint	Harold Bentley Avenue	Hunter Street	North Leg	-	-	-	-	-	-	-	-	-	-	-	
				South Leg	0	0	0	0	0	0	0	0	0	0		
				West Leg	0	0	0	0	0	0	0	0	0	0		
				East Leg	0	0	0	0	0	0	0	1	23	46		
				Intersection Total	0	0	0	0	0	0	0	1	23	46		
⑨	Paint	Harold Bentley Avenue	Northside Blvd.	North Leg	-	-	-	-	-	-	-	-	-	-	-	
				South Leg	1	158	316	2	0	0	0	0	0	0		
				West Leg	1	110	220	0	0	0	0	0	0	0		
				East Leg	1	109	218	0	0	0	0	0	0	0		
				Intersection Total	3	377	754	2	0	0	0	0	0	0		
<b>TOTAL</b>					10	1423	2846	108	3	2	98	147	10	259	518	

**FAIRBANKS AREA 1-6**

SEE SHEETS 3.13 & 3.14 FOR GENERAL STREET LOCATION

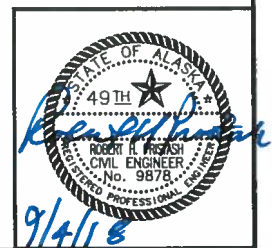

DATE	REVISION	BY

SCALE: NONE

DESIGNED: C.O.F. STAFF  
 DRAWN: C.O.F. STAFF  
 CHECKED: R.H.P.  
 DATE: 08/27/18

APPROVED  
 \_\_\_\_\_  
 CITY ENGINEER  
 DATE

**Transverse Pavement Markings**

CITY OF FAIRBANKS, ALASKA  
 Engineering Department  
 Project ITB-18-12

3.15  
 OF 18  
 SHEETS

Pavement Marking Type	Subdivision	Road	# of Speed Humps	
Paint	Hamilton Acres	Dunbar Ave	2	
	Hamilton Acres	Eureka Ave	5	
	Hamilton Acres	Farwell Ave	1	
	Hamilton Acres	Glacier Ave	6	
	Hamilton Acres	Haines Ave	4	
	Hamilton Acres	Ketchikan Ave	1	
	Hamilton Acres	Hamilton Ave	2	
	Hamilton Acres	B Street	3	
	Hamilton Acres	C Street	6	
	Hamilton Acres	D Street	6	
	Hamilton Acres	E Street	3	
	Hamilton Acres	F Street	5	
	<b>Hamilton Acres Total</b>			<b>44</b>
	Paint	Shannon Park	Joyce Dr	6
Shannon Park		Carlton Dr	1	
Shannon Park		Droz Dr	2	
Shannon Park		Cindy Dr	2	
Shannon Park		Lc-Arn Dr	3	
Shannon Park		Shannon Dr	7	
Shannon Park		Baranof Ave	3	
Shannon Park		Craig Ave	1	
Shannon Park		D Street	8	
Shannon Park		E Street	2	
Shannon Park		F Street	2	
<b>Shannon Park Total</b>			<b>37</b>	
Paint		Island Homes	Slater Dr	11
	Island Homes	Bentley Dr	6	
	Island Homes	Kody Dr	2	
<b>Island Homes Total</b>			<b>19</b>	
Paint	Grachl	40-mile Ave	2	
	Grachl	2nd Street	1	
<b>Grachl Total</b>			<b>3</b>	
Paint	Arctic Park	Lathrop St	2	
	Arctic Park	Kennicott Ave	3	
	Arctic Park	McCarty Ave	2	
<b>Arctic Park Total</b>			<b>7</b>	
Paint	Bjerremark	A-64	1	
	Bjerremark	A-64	1	
<b>Bjerremark Total</b>			<b>2</b>	

**SPEED HUMP**

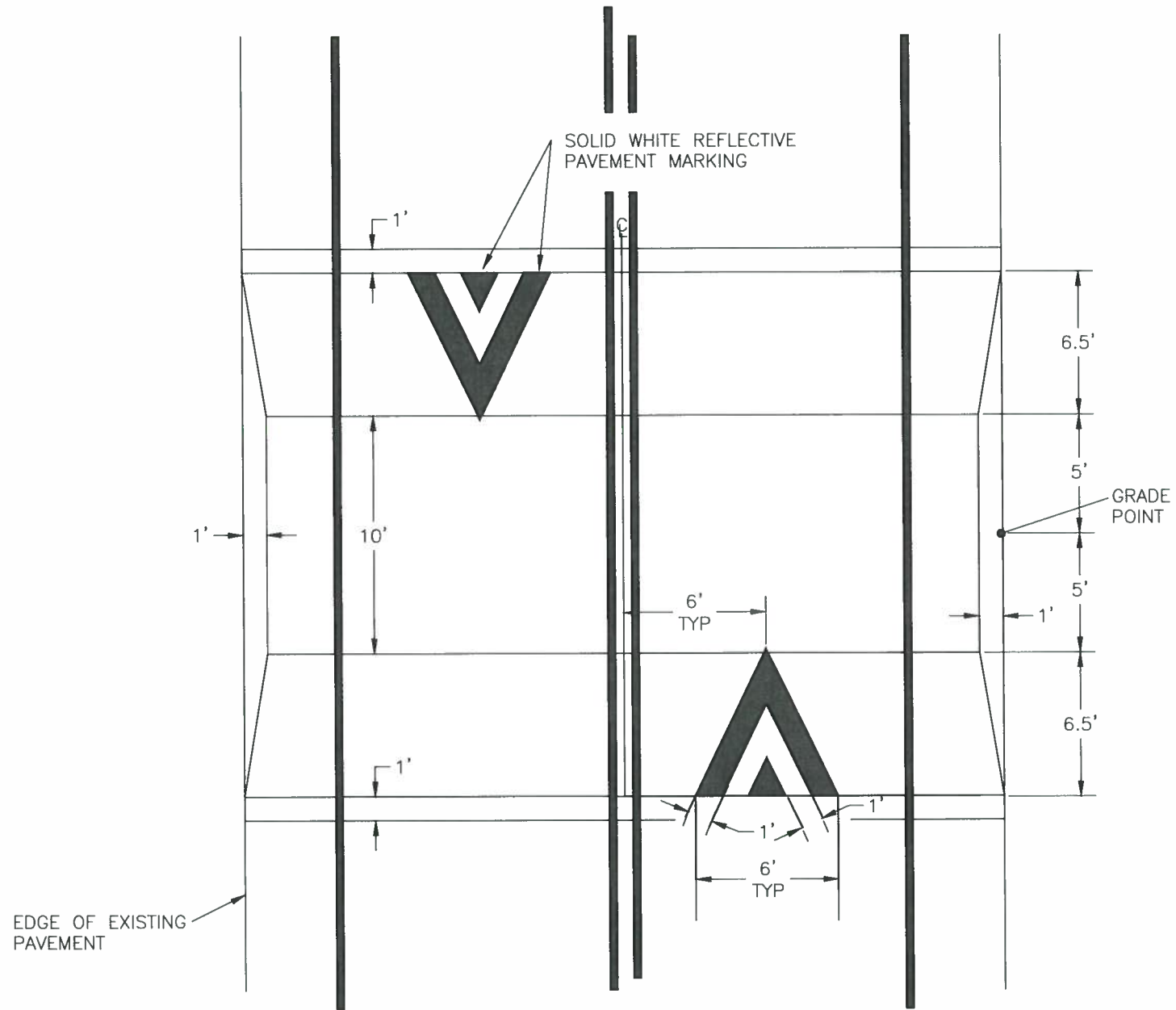

**PLAN VIEW**  
NOT TO SCALE

DATE	REVISION	BY

SCALE: NONE

DESIGNED: C.O.F. STAFF  
DRAWN: C.O.F. STAFF  
CHECKED: R.H.P.  
DATE: 08/27/18

APPROVED  
\_\_\_\_\_  
CITY ENGINEER  
DATE

**Transverse Pavement Markings**

CITY OF FAIRBANKS, ALASKA  
Engineering Department  
Project ITB-18-12

3.16  
OF 18  
SHEETS

